



CHIP-LOK™ COB Array Holder Installation Instructions

Models
50-2100NC, 50-2103NC
50-2100LG, 50-2100SH
50-2100BL, 50-2102CR
50-2103CT, 50-2234C

WARNING		
	Electrical Shock Hazard. Contact with high voltage may cause falling, serious injury, or death. Disconnect power before servicing. Never install holder without COB array.	
	Electrical Fire Hazard. Use in application exceeding voltage and current ratings listed can cause an electrical fire resulting in serious injury or death. Only use in accordance with Table 1 and local electrical wiring code.	

For factory assembly into portable lamps and luminaires.

TABLE 1: Rated Wire (Use copper conductors only)

WIRE TYPE	CAUS	EN 05 Pending
Solid	18-24 AWG	0,25 - 1,0 <input type="checkbox"/>
Tin Bonded	18-24 AWG	0,25 - 1,0 <input type="checkbox"/>
Stranded	18 -22 AWG	0,50 - 1,0 <input type="checkbox"/>
Voltage	250V	150V
Current	4A	2A
Temperature	110°C	T-110

Wire Insertion Instructions

- Strip wires to 7 mm (1/4"-5/16").
- Grip wire firmly and push conductor into wire port (Figure 1). Do not pre-twist stranded wire. Gently pull conductor to ensure proper insertion. Repeat with other wires.
- Use only one conductor per port and assure that no copper is exposed on any of the wires inserted.

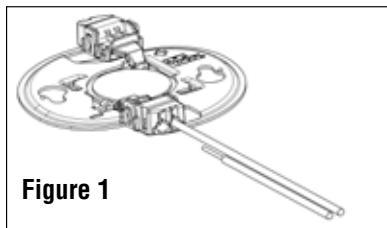
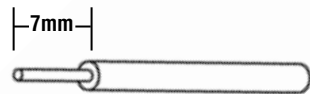

Figure 1



Installation Instructions:

- Preinstall M3 or #5 pan head screws into luminaire. (Except 50-2234C)
- Hold CHIP-LOK™ holder in one hand; LED array in other hand.
- Locate and align the "+" marking on both products.
- Set LED array into holder so that the edge of array touches side of spring leg. (Figure 2)
- Push array toward spring leg and down to seat into holder. (Never install holder without COB array.) Energizing luminaire without COB array installed could cause electrical shorting to heatsink.
- Apply thermal paste/pad to array or heatsink
- Insert holder/array assembly over screws through keyways (Figure 3) and rotate holder clockwise (Except 50-2234C).
- Tighten screw farther from spring leg first.
- Torque screws to 0.3 – 0.5 N-m (2.5 – 4.5 in-lb)

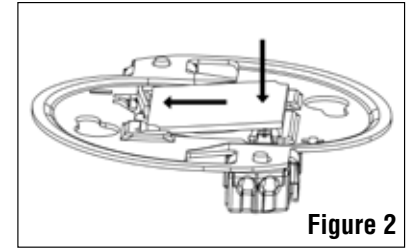

Figure 2

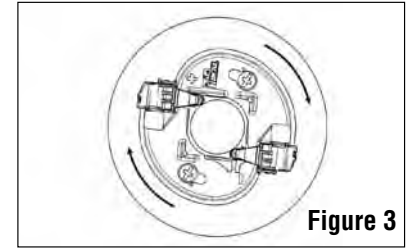

Figure 3

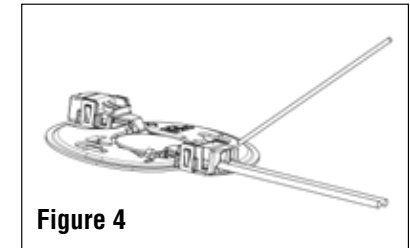

Figure 4

Removal of Wires:

- Insert a 0.040 inch (1 mm) diameter pin in to wire removal slot. (Figure 4)
- Pull wire to release.

IDEAL INDUSTRIES GmbH

Gutenbergstrasse 10
D - 85737 Ismaning, Germany
+49-89-99686-0
germanysales@idealnwd.com

IDEAL INDUSTRIES LIMITED

Unit 3, Europa Court, Europa Boulevard
Westbrook, Warrington, WA5 7TN
United Kingdom
+44 (0) 1925 444446
electrical.enquiries@idealnwd.com

IDEAL INDUSTRIES SAS

Route de Gisy, • ZA Burospace – Bât 7
F – 91571 Bievres Cedex • Bièvres, France
+33 (0) 1 69 35 54 70
francesales@idealnwd.com

IDEAL INDUSTRIES, INC.

Becker Place • Sycamore, IL 60178, U.S.A.
+1-800-324-9571 Customer Assistance
oem@idealindustries.com
www.idealindustries.com **ND 7868-4**

IDEAL INDUSTRIES ASIA LIMITED 美国理想工业

Tel: 86-21-31263188 Ext: 209
Address: No.61, Lane1000, Zhangheng Road, Pudong District, Shanghai, 201203, China
地址: 上海市浦东新区张衡路1000弄61号 邮编: 201203